

## What happens next

- Encourage all residents to respond to the November consultation
- Submission of outline planning application in early 2019
- Parish Council project team will develop business plan
- When planning decision known Parish Council will carefully evaluate options

## Conclusion

An exciting opportunity to provide imaginative leisure facilities and create a community hub enhancing the lives of many in our community, particularly children and younger people, and develop a unique facility for our two villages which will also be income generating to help meet ongoing maintenance costs.

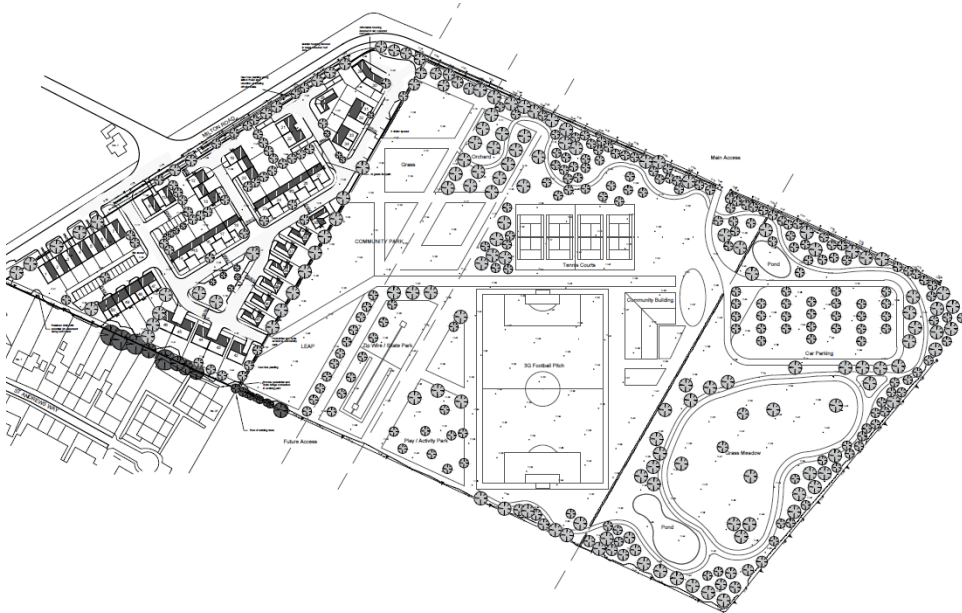

## Contact points

If you would like to become involved in the project please contact:

Neil Davies: [neil.davies@hisimp.net](mailto:neil.davies@hisimp.net) or

Deputy Clerk: [deputy.clerk@hisimp.net](mailto:deputy.clerk@hisimp.net)

Published November 2018



**A Histon & Impington Parish Council Project**



01223 235906



[clerk@hisimp.net](mailto:clerk@hisimp.net)



[www.hisimp.net](http://www.hisimp.net)

## Introduction

Histon & Impington is a thriving community, however there is a deficit in the provision of public open space and indoor space accommodation for dedicated community activities, and a shortage of social/affordable housing for village residents.

An opportunity has arisen with the landowners of 18 acres of land at Milton Road, Impington.



If planning permission is approved, Flagship Group will then transfer the freehold of 12 acres to Histon & Impington Parish Council for £1, and about 50 market/social/affordable housing units will be built on 6 acres. Flagship will also provide an agreed set of infrastructure works on the 12 acres which will form the Community Park. If it proceeds, the park will be named 'The Victor Unwin Community Park' in line with the land seller's wish.

## Recent Parish Council investments in facilities

The Community Park project will build on other Parish Council projects in the last two decades. In 2001 the Parish Council embarked on a bold vision to redevelop the Rec to encourage and increase community participation in leisure and sport.



The £1m project (with £500k raised in grants) was completed in 2006 and since then new sports clubs have formed and participation in sports clubs and new activities for all ages has increased substantially.

Later in 2009 the Recreation Ground play area was completely transformed with a £100k investment into the upgraded play which is much loved by village children and the Play area on the Green was updated in 2012 at a sizeable cost.

## The Victor Unwin Community Park

The Parish Council has agreed a list of aspirational community facilities that are to be included in the outline planning application Flagship is making. The Parish Council has at present made no commitment to provide the facilities.

### Open space

- 50% shortfall in public open space provision
- Enhanced biodiversity with extensive landscaping and pond area, maintaining the openness of Green Belt
- Paths to be created in an area where few exist

### Community building

- Village community centre with a potential connectivity to all residents
- Inadequate and failing range of accommodation for uniformed organisations
- Encourage heritage, arts and community cohesion

### Tennis courts

- New artificial floodlit courts will facilitate all year round play
- Relocation of courts from Recreation Ground provides opportunity to reconfigure entrance, car parking & play area

### Activity/ skatepark

- Long term 20 year search for suitable site
- Sustained and organised engagement with continuous demand from young people and supportive parents

### 3G artificial football pitch

- Shortage of playing pitches and training pitches in village
- No floodlit training facility in village other than small Rec MUGA
- Positive support from football authorities

